



LuxteL[®] llc

CeraLux[®] Xenon Arc Lamps

CeraLux Xenon Lamp - C Body Size - VIDEO LAMPS

LuxteL now offers an alternative lamp design to other C size ceramic lamps. Our C body size lamp is compatible with that of PerkinElmer, yet provides an improved cooling design.

The lamps offered here are designed to be used with existing video systems at pre-determined power levels. Call upon us to optimize one for your application.

We will show you how easy it is to use your existing hardware, re-trofit with ours or customize your own design to optimize your system's performance.

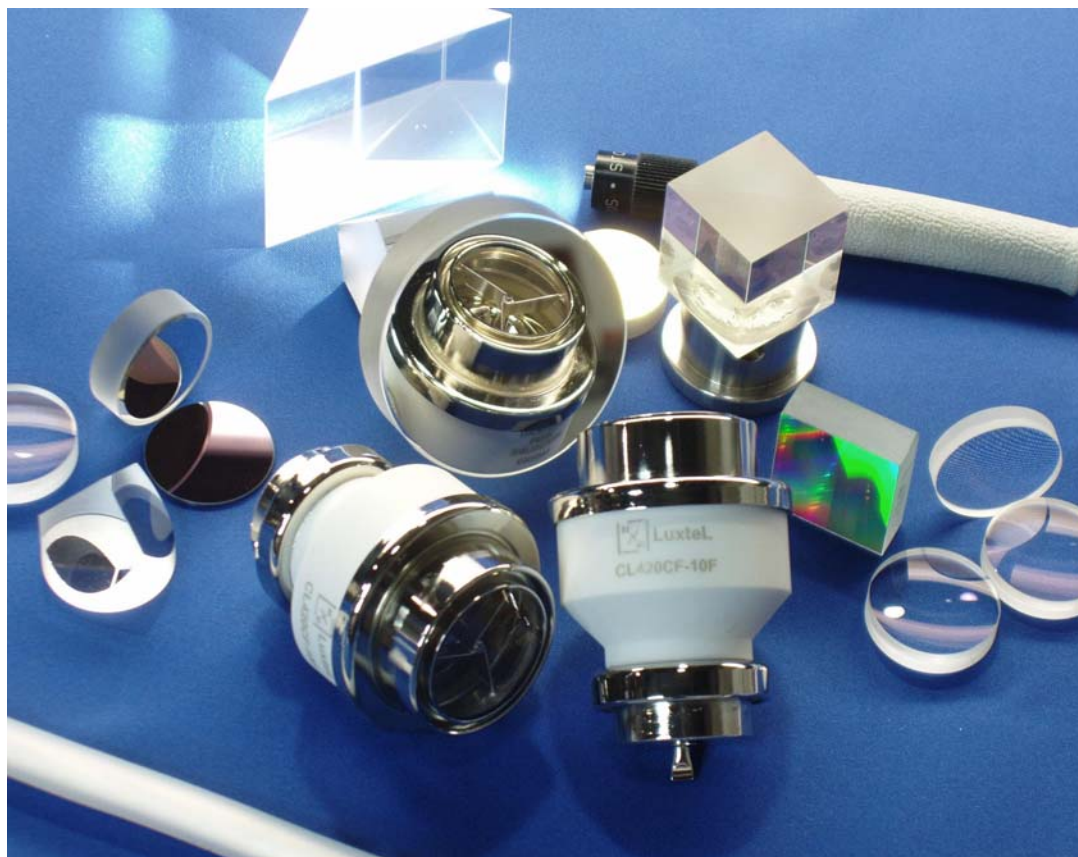

CeraLux Xenon Focused Arc Lamps With Elliptical Reflectors C Body Size - VIDEO LAMPS



REFLECTOR SPECIFICATION

F 1.0
M = 1.2136
N = .7129

F 1.3
M = 1.3648
N = .7311

REFLECTOR EQUATION

$$1 = \frac{X^2}{M^2} + \frac{Y^2}{N^2}$$

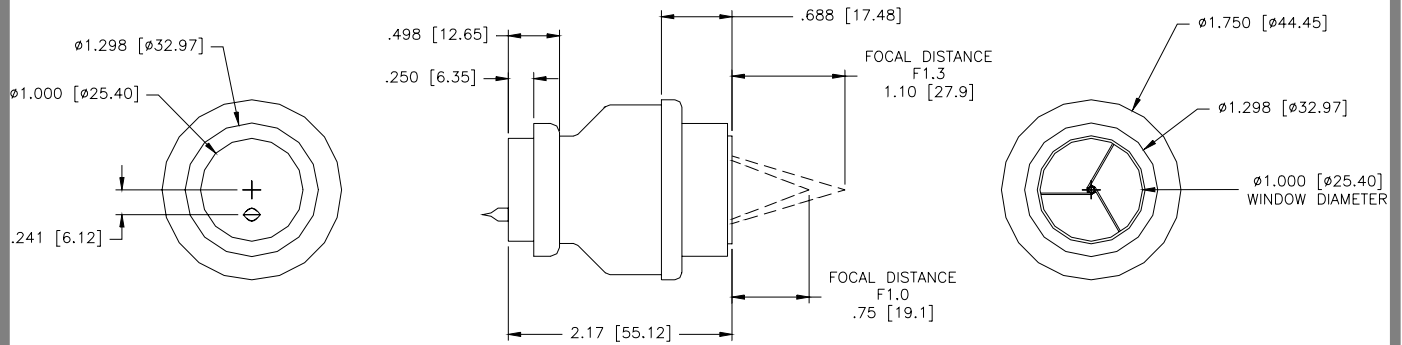

DIMENSIONS IN BRACKETS ARE IN MILLIMETERS

OPERATIONAL SPECIFICATIONS FOR VIDEO LAMPS

	CL330CF-10F	CL330CF-13F	CL420CF-10F	CL420CF-13F	CL550CF-10F	CL550CF-13F
POWER (watts)						
Nominal	330	330	420	420	550	550
Range	270-390	270-390	350-420	350-420	400-575	400-575
CURRENT (amps DC)						
Nominal	23	23	26	26	35	35
Range	21-27	21-27	24-28	24-28	32-38	32-38
VOLTAGE (volts DC)						
Nominal	15	15	16	16	16	16
Range	14-17	14-17	15-17	15-17	15-18	15-18
Minimum Ignition Voltage (kV)	30	30	30	30	30	30
OUTPUT AT NOMINAL POWER						
Radiant Output (watts)	70	70	82	82	120	120
Visible Output (lumens)	6800	6800	7800	7800	11500	11500
UV Output (watts)	3	3	4	4	6	6
IR Output (watts)	40	40	48	48	70	70
Color Temperature (°K)	5900	5900	5900	5900	5900	5900

All values and specifications are subject to change without notice.

Luxtel LLC 100 Ferncroft Road, Danvers, MA USA 01923 PH 978.774.9136 FAX 978.774.1559 e-mail: info@luxtel.net